

# QUICK CONNECT GUIDE KAMAI 500

SET-TOP BOX WITH WIRELESS ADAPTER

For detailed information on how to use your Set-Top Box guide including DVR functions, Parental Controls and more, visit [execulink.ca/stb-guide](http://execulink.ca/stb-guide).

**NEED HELP?**

CONTACT US AT 1.866.706.2053  
OR [EXECULINK.CA/LINKTVSUPPORT](http://EXECULINK.CA/LINKTVSUPPORT)

## STEP 2: CONNECT TO TV

1. Move the Set-Top Box to your desired TV.
2. Connect the HDMI cord from the Set-Top Box to an HDMI port on your TV.
3. Plug in the power cord to both the Set-Top Box and a wall outlet.

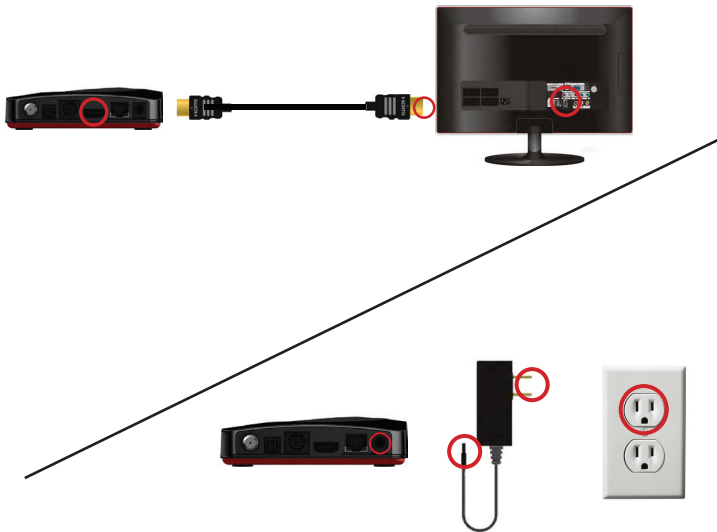

## STEP 4: SETUP REMOTE CONTROL

1. Open the battery cover by pressing down on the battery cover latch and sliding it off.
2. Insert the batteries, matching the + and - marks on the batteries with the interior of the remote control.
3. Snap the battery cover to close.

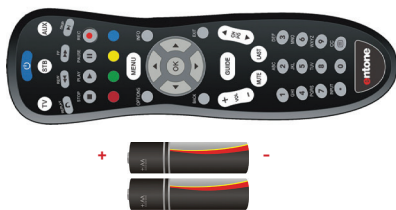

Please note: Make sure your TV is turned on and the correct video input is selected.

## STEP 1: DOUBLE CHECK

Make sure you have the following components available to complete the setup of your TV service.

|  |  |
|--|--|
| KAMAI 500 Set-Top Box & Power Adapter  |  |
| Wireless Adapter<br><i>(Your adapter may look like either one indicated here.)</i> |  |
| Remote Control & Batteries (x2)  |  |
| Ethernet Cable   |  |
| HDMI Cable   |  |

## STEP 3: INSERT WIRELESS ADAPTER

1. Insert your Wireless Adapter to the side of the Set-Top Box (will differ slightly depending on which Wireless adapter you have).
2. Your Set-Top Box will now boot up.

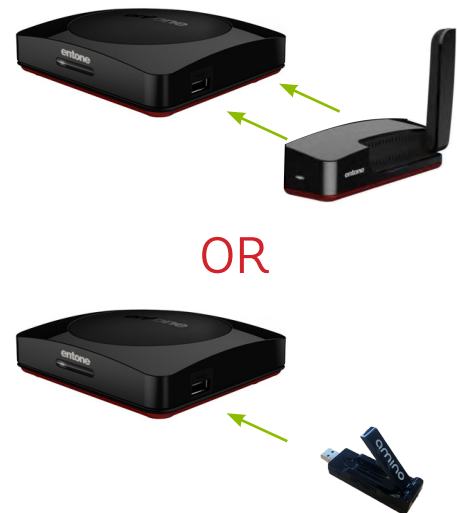

## STEP 5: SETUP NETWORK

1. After boot up, you will be greeted with a screen to select a wireless network.
2. For the best experience, always choose a 5GHz network if available.
3. Once your wireless network credentials are correctly entered, your Set-Top Box now has a wireless connection.

Please note: If you accidentally disconnect your Wireless Adapter, simply plug it in again and reboot your Set-Top Box.

**DONE!**

**NEED HELP?**

CONTACT US AT 1.866.706.2053  
OR [EXECULINK.CA/LINKTVSUPPORT](http://EXECULINK.CA/LINKTVSUPPORT)