

QUICK CONNECT GUIDE

KAMAI 7XM

MOCA SET-TOP BOX

For detailed information on how to use your Set-Top Box guide including DVR functions, Parental Controls and more, visit execulink.ca/stb-guide.

NEED HELP?

CONTACT US AT 1.866.706.2053
OR EXECULINK.CA/SUPPORT

STEP 2: CONNECT TO SET-TOP BOX

1. Move the Set-Top Box to your desired TV, near the installed coaxial cable.
2. Plug the coaxial cable back into the coaxial port at the back of the Set-Top Box. When re-adding the coax be sure to thread it correctly and make sure it is tight.



STEP 4: SETUP REMOTE CONTROL

1. Open the battery cover by pressing down on the battery cover latch and sliding it off.
2. Insert the batteries, matching the + and - marks on the batteries with the interior of the remote control.
3. Snap the battery cover to close.

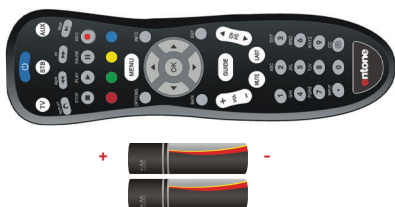

NEED HELP?

CONTACT US AT 1.866.706.2053
OR EXECULINK.CA/LINKTVSUPPORT

STEP 1: DOUBLE CHECK

Make sure you have the following components available to complete the setup of your TV service.

KAMAI 7XM Set-Top Box & Power Adapter



Remote Control & Batteries (x2)



HDMI Cable



Installed Coaxial Cable



STEP 3: CONNECT TO TV & POWER

1. Connect the HDMI cord into the HDMI port in the back of the Set-Top Box.
2. Plug the other end of the HDMI cable into an HDMI port on your TV.
3. Plug the power cord into the back of the Set-Top Box and the other end into a wall outlet.

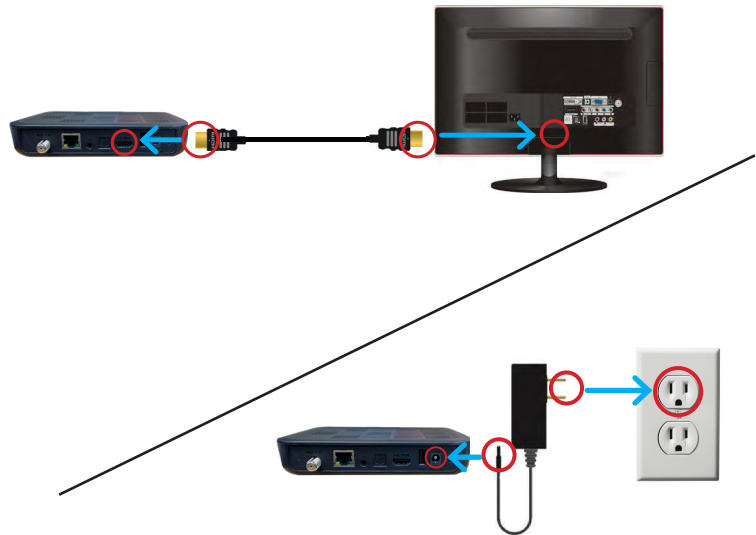

STEP 5: TURN ON TV

Turn on the TV and select the correct video input.

DONE!



For detailed information on how to use your Set-Top Box guide including DVR functions, Parental Controls and more, visit execulink.ca/stb-guide.